

This Drawing is Copyright - © The Tree File Ltd 2021

Clonliffe Tree Impacts Plan NW 1/1 Scale 1:500 @ A1

This is a colour coded drawing that will be difficult or impossible to interpret if reproduced in black and white

Ashgrove House  
26 Foxrock Park  
Dublin 18



Mob. 086-3819011  
e-mail - thetreefile@eircom.net

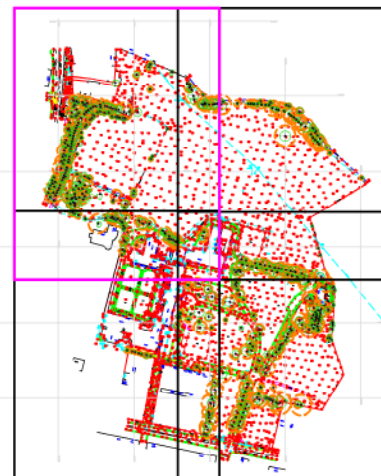

Colour Coding of Tree Impacts

- Trees Intended for Retention - Solid Green Crown Outline
- Trees Intended for Removal in Conjunction With Development Works - Broken Pink Crown Outline

Colour Coding of Tree Categories

- Category "A" Trees (Green Button)
- Category "B" Trees (Blue Button)
- Category "C" Trees (Gray Button)
- Category "U" Trees (Red Button)

Graphic Representation of Tree and Protection Zone

- Canopy Extent
- Cardinal Radii
- Category Code
- Stem Circumference
- Canopy is drawn to account for any natural asymmetry or imbalance. Crown Representation is scaled to account for north, east, west and south mill.
- Root Protection Area (RPA)  
This area relates the "RPA" radius as defined in the Tree Survey Table and is measured from the tree centre. This area defines the preliminary Construction Exclusion Zone (CEZ) that must be protected by fencing from the potentially damaging affects of construction activity.

Client: CWTC Multi Family ICAV acting on behalf of its sub-fund DBTR DR1 Fund  
Scale: 1:500 Date: April 2021  
Project: Tree survey, Holy Cross College, Clonliffe Road, Dublin 3 and Drumcondra Road Lower, Drumcondra, Dublin 9  
Description: Tree Impacts Plan  
Drawing Title: Clonliffe Tree Impacts Plan NW